

100 +/- ACRES MURRAY COUNTY LAND AUCTION

**Fulda Community Center, Fulda, MN
Thursday, October 2, 2025 - 10:00 AM**

Location: 1 mile North of Fulda on County Road 39, ½ mile West on County Road 72

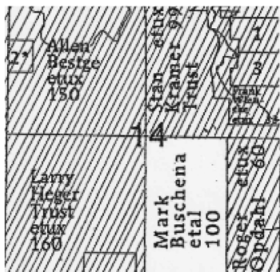

Legal Description: west 100 Acres in Southeast Quarter (SE ¼) Section 14-T105N-R40W, Bondin Twp. Murray County, MN

General Information: Unimproved 100 acres-more or less, CER 74.8, CPI- 90.9.

FSA Information: 97.93 acres tillable, 50.8 acre corn base, PLC Corn Yields 173 bu, 25.7 acre Soybean base, PLC Soybean Yield 49 bu.

For Additional Information or Inspection: Contact Larry Aanenson at 507-227-0118, or look at your leisure, or go to our web-site at www.aanenson.com for additional information. (handouts available).

Buschena Heirs- Owners

Paul Malone, Closing Attorney

All announcements made day of auction supersede this and all other advertisements printed or implied.
AUCTION ARRANGED AND CONDUCTED BY:

Aanenson Realty & Auction Co.

Larry H. Aanenson, Lic. # 51-41
Auctioneer/ RE Broker
Fulda, MN
Cell 507-227-0118

www.aanenson.com

Tyson Meyeraan, Lic. #51-46
Auctioneer/ Sales Person
Fulda, MN
Ph. 507-360-3971

"Experience and service you expect and deserve!"

Not responsible for accidents